

P4SMA-Q Series

Surface Mount – 400W

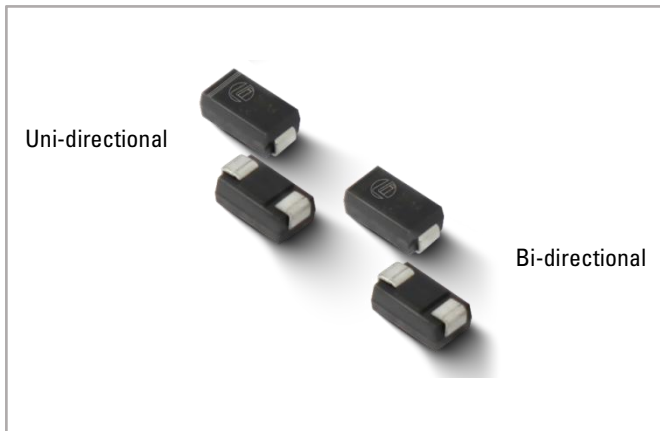

Additional Information



Resources



Accessories



Samples

Maximum Ratings and Thermal Characteristics

($T_A=25^\circ\text{C}$ unless otherwise noted)

Parameter	Symbol	Value	Unit
Peak Pulse Power Dissipation by 10/1000 μs Waveform(Fig.1)(Note1)(Note2) -Single Die Parts)	P_{PPM}	400	W
Power Dissipation on Infinite Heat Sink at $T_L=50^\circ\text{C}$	P_D	3.3	W
Peak Forward Surge Current, 8.3ms Single Half Sine Wave (Note 3)	I_{FSM}	60	A
Maximum Instantaneous Forward Voltage at 25A for Unidirectional Only (Note 4)	V_F	3.5/5.0	V
Operating Temperature Range	T_J	-55 to 150	$^\circ\text{C}$
Storage Temperature Range	T_{STG}	-55 to 150	$^\circ\text{C}$
Typical Thermal Resistance Junction to Lead	$R_{\theta JL}$	30	$^\circ\text{C}/\text{W}$
Typical Thermal Resistance Junction to Ambient	$R_{\theta JA}$	120	$^\circ\text{C}/\text{W}$

Notes:

1. Non-repetitive current pulse, per Fig.3 and derated above T_J (initial) $=25^\circ\text{C}$ per Fig.2.
2. Mounted on 5.0x5.0mm copper pad to each terminal.
3. Measured on 8.3ms single half sine wave or equivalent square wave for unidirectional device only.
4. $V_F < 3.5\text{V}$ for single die parts and $V_F < 5.0\text{V}$ for stacked-die parts.

Description

The P4SMA-Q series is designed specifically to protect sensitive electronic equipment from voltage transients induced by lightning and other transient voltage events.

Features

- High reliability application and automotive grade AEC-Q101 qualified
- 400W peak pulse power capability at 10/1000 μs waveform, repetition rate (duty cycles):0.01%
- Excellent clamping capability
- Typical I_R less than 1 μA when $V_B \text{ min} > 12\text{V}$
- Surface mount footprint for compact PCB layout
- Low profile package
- Typical failure mode due to exceeding maximum ratings is a short circuit condition
- Whisker test conducted based on Table 4a and 4c of JEDECJESD201A
- ESD protection of data lines in accordance with IEC 61000-4-2, 30kV(Air), 30kV (Contact)
- EFT protection of data lines in accordance with IEC61000-4-4
- Built-in strain relief
- Fast response time: typically less than 1.0ps from 0V to V_B min
- High temperature to reflow soldering guaranteed: 260 $^\circ\text{C}/20\sim 40\text{sec}$.
- $V_B @ T_J = V_B @ 25^\circ\text{C} \times (1 + \alpha T)$ (α T:Temperature Coefficient, typical value is 0.1%)
- Meet MSL level1, per J-STD-020, LF maximum peak of 260 $^\circ\text{C}$
- Matte tin, lead-free plated
- Halogen free and RoHS compliant
- Pb-free E3 means 2nd level interconnect is Pb-free and the terminal finish material is tin(Sn) (IPC/JEDEC J-STD 609A.01)

Applications

TVS devices are ideal for the protection of I/O Interfaces, V_{CC} bus and other vulnerable circuits used in Telecom, Computer, Industrial and Consumer electronic applications.

Functional Diagram

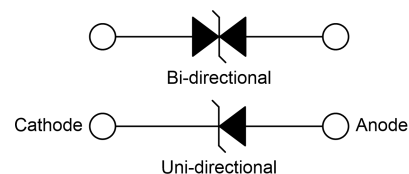

P4SMA-Q Series

Surface Mount – 400W

Electrical Characteristics ($T_A=25^\circ\text{C}$ unless otherwise noted)

Part Number		Type	Device Marking Code		Reverse Stand-Off Voltage $V_R(V)$	Breakdown Voltage @ I_T		Test Current $I_T(mA)$	Maximum Clamping Voltage @ I_{PP} $V_C(V)$	Peak Pulse Current $I_{PP}(A)$	Reverse Leakage @ V_R $I_R(\mu A)$
Uni.	Bi.		Uni.	Bi.		$V_{B Min.}(V)$	$V_{B Max.}(V)$				
P4SMA6.8A	P4SMA6.8CA	Q	6V8A	6V8C	5.80	6.45	7.14	10	10.5	39.0	1000
P4SMA7.5A	P4SMA7.5CA	Q	7V5A	7V5C	6.40	7.13	7.88	10	11.3	36.3	500
P4SMA8.2A	P4SMA8.2CA	Q	8V2A	8V2C	7.02	7.79	8.61	10	12.1	33.9	200
P4SMA9.1A	P4SMA9.1CA	Q	9V1A	9V1C	7.78	8.65	9.55	1	13.4	30.6	50
P4SMA10A	P4SMA10CA	Q	10A	10C	8.55	9.50	10.50	1	14.5	28.3	10
P4SMA11A	P4SMA11CA	Q	11A	11C	9.40	10.50	11.60	1	15.6	26.3	5
P4SMA12A	P4SMA12CA	Q	12A	12C	10.20	11.40	12.60	1	16.7	24.6	5
P4SMA13A	P4SMA13CA	Q	13A	13C	11.10	12.40	13.70	1	18.2	22.5	1
P4SMA15A	P4SMA15CA	Q	15A	15C	12.80	14.30	15.80	1	21.2	19.3	1
P4SMA16A	P4SMA16CA	Q	16A	16C	13.60	15.20	16.80	1	22.5	18.2	1
P4SMA18A	P4SMA18CA	Q	18A	18C	15.30	17.10	18.90	1	25.2	16.1	1
P4SMA20A	P4SMA20CA	Q	20A	20C	17.10	19.00	21.00	1	27.7	14.8	1
P4SMA22A	P4SMA22CA	Q	22A	22C	18.80	20.90	23.10	1	30.6	13.4	1
P4SMA24A	P4SMA24CA	Q	24A	24C	20.50	22.80	25.20	1	33.2	12.3	1
P4SMA27A	P4SMA27CA	Q	27A	27C	23.10	25.70	28.40	1	37.5	10.9	1
P4SMA30A	P4SMA30CA	Q	30A	30C	25.60	28.50	31.50	1	41.4	9.9	1
P4SMA33A	P4SMA33CA	Q	33A	33C	28.20	31.40	34.70	1	45.7	9.0	1
P4SMA36A	P4SMA36CA	Q	36A	36C	30.80	34.20	37.80	1	49.9	8.2	1
P4SMA39A	P4SMA39CA	Q	39A	39C	33.30	37.10	41.00	1	53.9	7.6	1
P4SMA43A	P4SMA43CA	Q	43A	43C	36.80	40.90	45.20	1	59.3	6.9	1
P4SMA47A	P4SMA47CA	Q	47A	47C	40.20	44.70	49.40	1	64.8	6.3	1
P4SMA51A	P4SMA51CA	Q	51A	51C	43.60	48.50	53.60	1	70.1	5.8	1
P4SMA56A	P4SMA56CA	Q	56A	56C	47.80	53.20	58.80	1	77.0	5.3	1
P4SMA62A	P4SMA62CA	Q	62A	62C	53.00	58.90	65.10	1	85.0	4.8	1
P4SMA68A	P4SMA68CA	Q	68A	68C	58.10	64.60	71.40	1	92.0	4.5	1
P4SMA75A	P4SMA75CA	Q	75A	75C	64.10	71.30	78.80	1	103.0	4.0	1
P4SMA82A	P4SMA82CA	Q	82A	82C	70.10	77.90	86.10	1	113.0	3.6	1
P4SMA91A	P4SMA91CA	Q	91A	91C	77.80	86.50	95.50	1	125.0	3.3	1
P4SMA100A	P4SMA100CA	Q	100A	100C	85.50	95.00	105.00	1	137.0	3.0	1
P4SMA110A	P4SMA110CA	Q	110A	110C	94.00	105.00	116.00	1	152.0	2.7	1
P4SMA120A	P4SMA120CA	Q	120A	120C	102.00	114.00	126.00	1	165.0	2.5	1
P4SMA130A	P4SMA130CA	Q	130A	130C	111.00	124.00	137.00	1	179.0	2.3	1
P4SMA150A	P4SMA150CA	Q	150A	150C	128.00	143.00	158.00	1	207.0	2.0	1
P4SMA160A	P4SMA160CA	Q	160A	160C	136.00	152.00	168.00	1	219.0	1.9	1
P4SMA170A	P4SMA170CA	Q	170A	170C	145.00	162.00	179.00	1	234.0	1.8	1
P4SMA180A	P4SMA180CA	Q	180A	180C	154.00	171.00	189.00	1	246.0	1.7	1
P4SMA200A	P4SMA200CA	Q	200A	200C	171.00	190.00	210.00	1	274.0	1.5	1
P4SMA220A	P4SMA220CA	Q	220A	220C	185.00	209.00	231.00	1	328.0	1.3	1
P4SMA250A	P4SMA250CA	Q	250A	250C	214.00	237.00	263.00	1	344.0	1.2	1
P4SMA300A	P4SMA300CA	Q	300A	300C	256.00	285.00	315.00	1	414.0	1.0	1

Notes:

For bidirectional type having V_R of 10 volts and less, the I_R limit is double.
 $V_R @ T_A = V_R @ 25^\circ\text{C} \times (1 + \alpha T \times (T_A - 25))$ (αT : Temperature Coefficient)

P4SMA-Q Series

Surface Mount – 400W

Ratings and Characteristic Curves ($T_A=25^\circ\text{C}$ unless otherwise noted)

Figure 1:
Peak Pulse Power Rating Curve

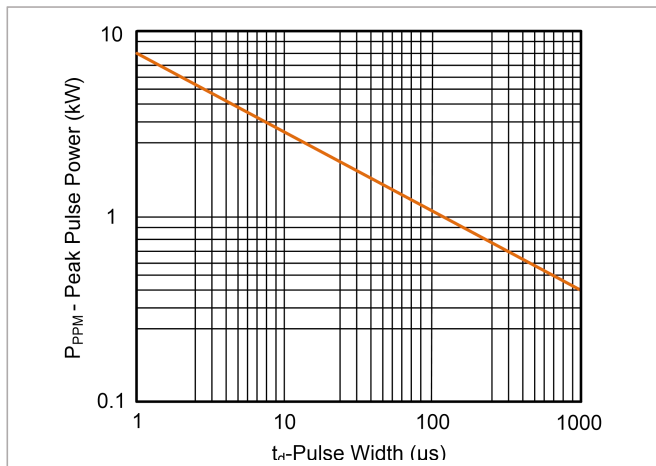

Figure 2:
Pulse Derating Curve

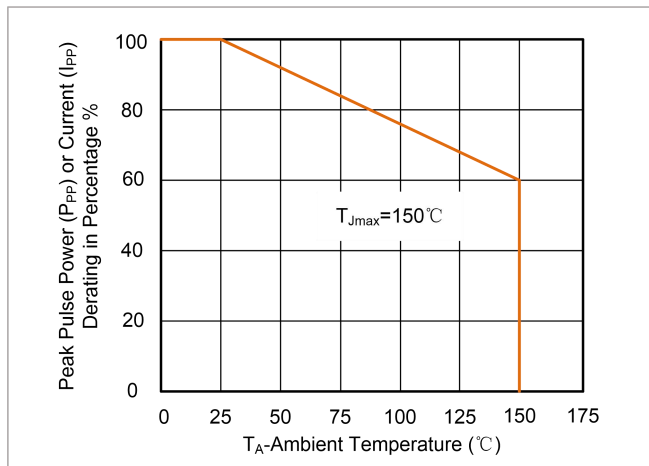

Figure 3:
Pulse Waveform

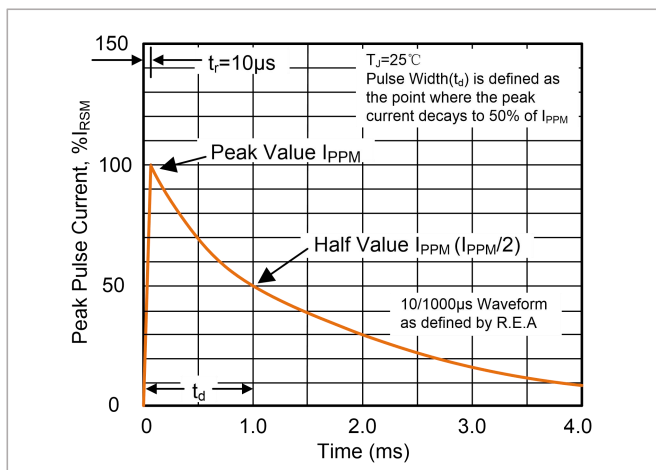

Figure 4:
Typical Junction Capacitance

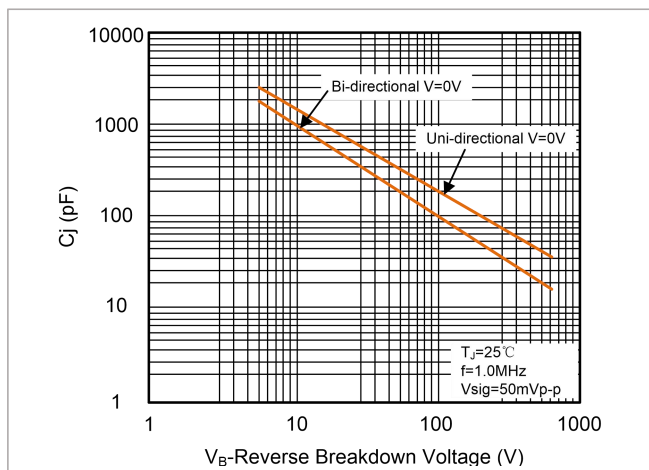

Figure 5:
Steady State Power Dissipation Derating Curve

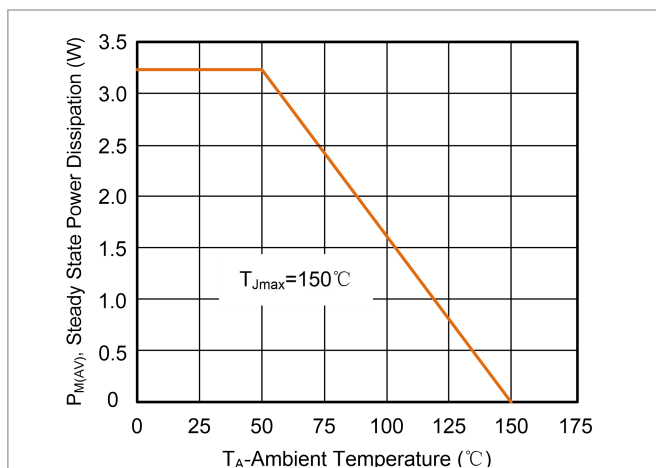
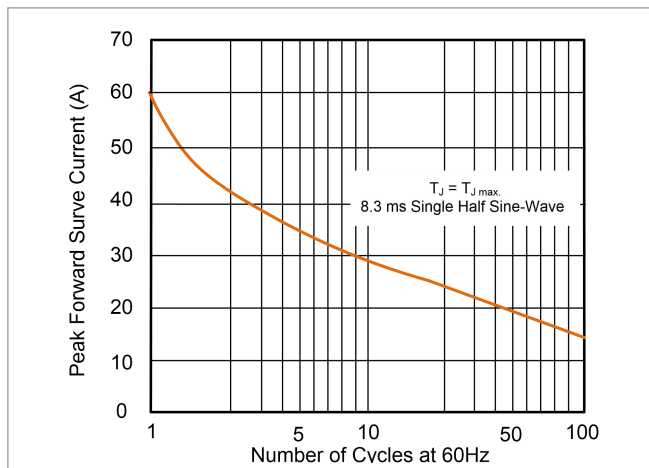

Figure 6:
Maximum Non-Repetitive Forward Surge Current Uni-Directional



P4SMA-Q Series

Surface Mount – 400W

Soldering Parameters

Reflow Condition		Lead-free assembly
Pre Heat	-Temperature Min ($T_{S\ min}$)	150°C
	-Temperature Max ($T_{S\ max}$)	200°C
	-Time (min to max) (t_s)	60 – 180 secs
Average ramp-up rate(Liquidus Temp (T_L) to peak		3°C/second max.
$T_{S\ (max)}$ to T_L-Ramp-up Rate		3°C/second max.
Reflow	-Temperature (T_L) (Liquidus)	217°C
	-Time (min to max) (t_L)	60-150 seconds
Peak Temperature (T_P)		260°C
Time within 5°C of actual Peak Temperature (t_p)		20-40 seconds
Ramp-down Rate		6°C/second max.
Time 25°C to Peak Temperature		8 minutes max.
Do not exceed		260°C

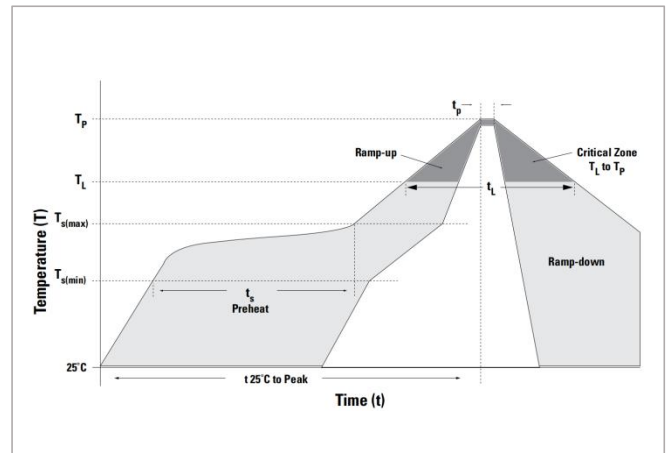

Dimensions

DO-214AC (SMA)

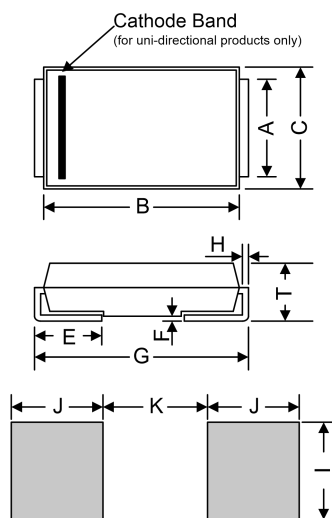

Symbol	Millimeters		Inches	
	Min.	Max.	Min.	Max.
A	1.250	1.650	0.049	0.065
B	3.990	4.600	0.157	0.181
C	2.400	2.790	0.095	0.110
E	0.780	1.520	0.030	0.060
F	-	0.203	-	0.008
G	4.800	5.280	0.189	0.208
H	0.152	0.305	0.006	0.012
T	1.900	2.290	0.075	0.090
I	1.800	-	0.070	-
J	2.100	-	0.082	-
K	-	2.300	-	0.090

Part Numbering System

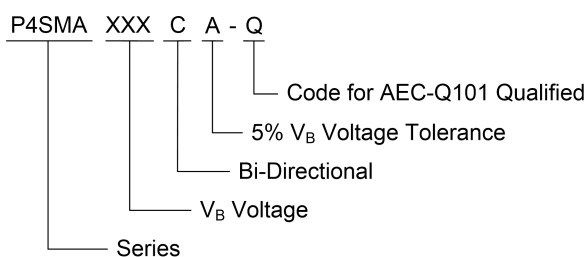

Part Marking System

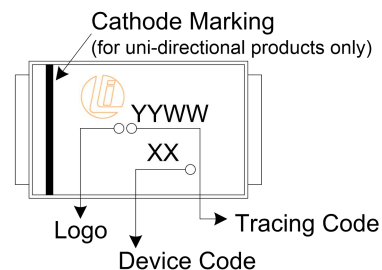

P4SMA-Q Series

Surface Mount – 400W

Packaging

Part number	Component Package	Quantity	Packaging Option	Packaging Specification
P4SMAxxxXX-Q	DO-214AC	5000	Tape & Reel - 12mm tape/13" reel	EIA STD RS-481

Tape and Reel Specification

Tape

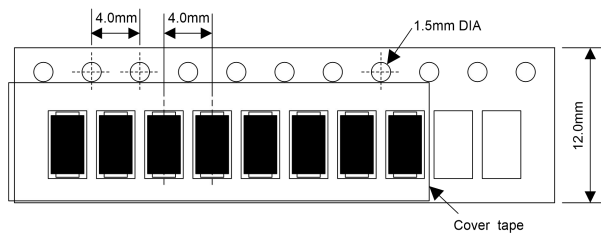

For Uni-Devices

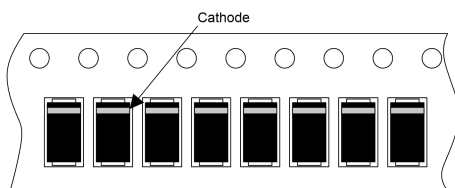

13 Inches Reel

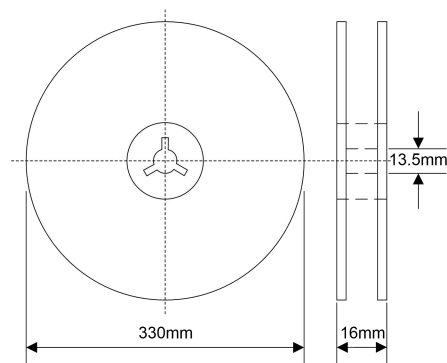

Quantity: 5000pcs/reel

Disclaimer Notice - Information furnished is believed to be accurate and reliable. However, users should independently evaluate the suitability of and test each product selected for their own applications. Liown products are not designed for, and may not be used in, all applications. Read complete Disclaimer Notice at <http://www.liownsemi.com>